



***UNIVERSAL
TUBELESS TIRE
SEALANT***

PRODUCT DESCRIPTION





Vittoria Universal Tubeless tire sealant is an high performance tire sealant with high concentration particles. Thanks to special formulation it can seals holes up to 7mm on mountain bike tires and up to 5mm on road bike tires and it guarantee a great sealing performance up to 1000km.

MAIN CHARACTERISTICS

- Zero Natural Latex so no risk of an allergic reaction.
- Zero Ammonia.
- Biodegradable Particulate.
- Seals up to 7mm holes instantly (MTB tires).
- Seals up to 5mm holes instantly (Road tires) 23c/25c and up to 6mm on 28c.
- Shelf life of 26 months from date of production.
- Excellent air retention.
- Can be air shipped safely.
- Applied through a Presta Valve stem or directly into the tire.
- Good puncture sealing performance up to 1000 km.
- Recommended top up through the valve every 3- 5 months or over 1200 km.
- Won't freeze up to -15° C
- Compatible with CO2. However, a direct blast of CO2 into the liquid is not ideal.
- Compatible with latex inner tubes.
- Vittoria Universal tubeless tire sealant is the only recommended with Vittoria AIR-LINER inserts.

PERFORMANCE COMPARISON - PUNCH TEST

TEST PROTOCOL: Tire 27.5" x 2.35"- Air Pressure: 35psi- Punch tool: Ø 6mm. First puncture the tire, remove the punch tool and spin the wheel (5x rotations). Check puncture point for sealing. Check loss of pressure. Check again the tire pressure after 24 Hours and 72 Hours.

Sealant	Sealing Time	Air Pressure after sealing	Air Pressure after 24h	Air Pressure after 72h	Total loss (psi)	Percentage loss	Ammonia Free	Latex Free
 VITTORIA	3 seconds	32psi	31psi	29psi	3psi	9.4%	✓	✓
	2 seconds	32.5psi	32psi	29psi	3.5psi	10.4%	✓	✗
	4 seconds	28psi	18psi	flat			✗	✗
	15 seconds	18psi	flat				✓	Synthetic Latex
	Didn't seal	Didn't seal					✓	✓

INSTRUCTION USE

Sealant Bottle Application Instructions

1. Inflate the tire once without sealant to seat the tire beads on the bead seat then let the air out.
2. Remove the valve core with the POM Lid Cap valve removal tool.
3. Give the Bottle "A."
4. Position the valve at the 12 o'clock position.
5. Push the nozzle over the Tubeless Valve Stem till it bottoms out and then thread it on to secure it.
6. Move the valve to the 7 o'clock position.
7. Squeeze the required sealant volume into the tire. Then turn the valve back to the 12 o'clock position.
8. Unscrew the nozzle and replace the threaded cap. (Valve core tool)
9. Slowly rotate the wheel 360 degrees twice in both directions.
10. Place the wheel upright and using a tubeless compatible floor pump inflate the tire.

RECOMMENDED VOLUME PER TIRE

	TIRE SIZE	SEALANT
ROAD TIRES	700x23c/28c	40ml
	700x29c/35c	50ml
GRAVEL TIRES	700x35c/45c	60ml
	700x45c/55c	70ml
MTB XC TIRES	29"x 1.8"/2.1"	70ml
	29"x 2.1"/2.25"	80ml
	29"x 2.3"/2.4"	90ml
MTB TRAIL/ENDURO TIRES	27.5"/29"x 2.4"/2.5"	120ml
	27.5"/29"x 2.6"/2.8"	150ml
FAT BIKE TIRES	3" - 4"	250ml

Please note this is a guide and the user is advised to take tire size and riding environment into consideration. Recommended top up through the valve every 3/5 months or over 1200 km.

SPECIAL BOTTLE CAP + LID

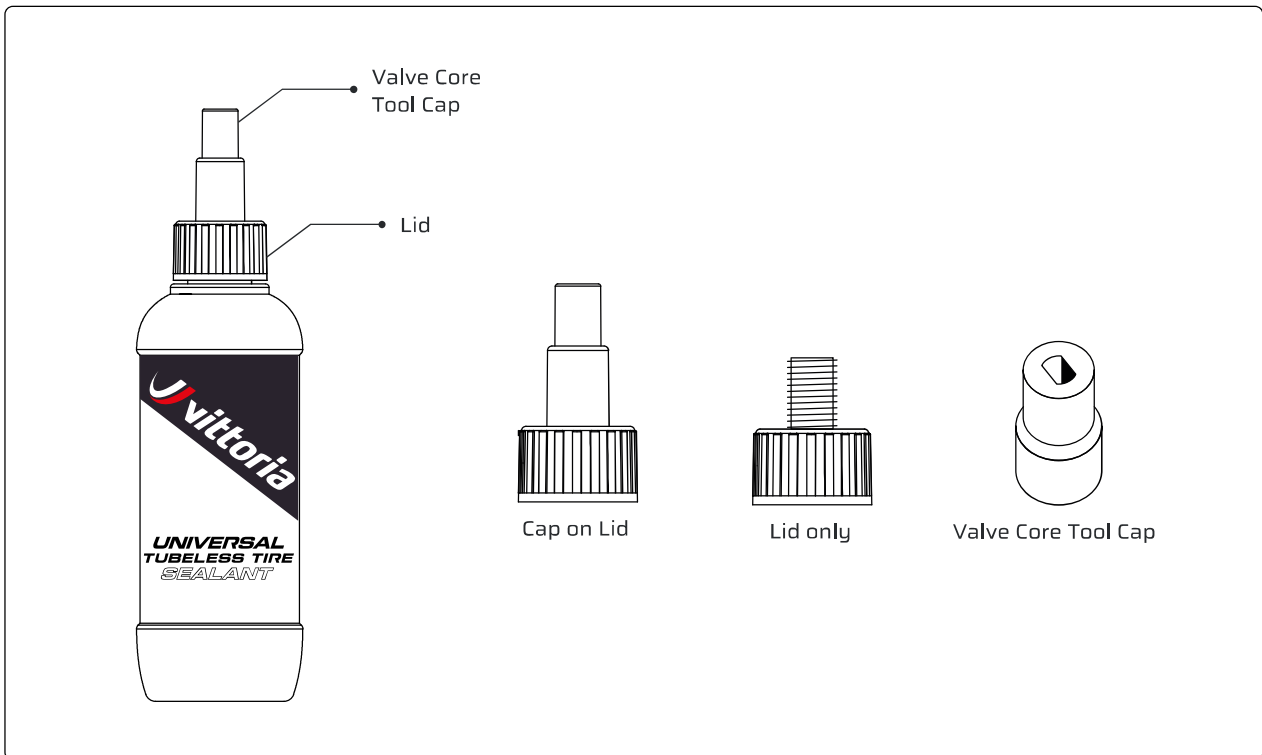

LID CAP INSTRUCTIONS

Threaded lid Cap with built-in Presta valve core tool made out of hard POM plastic for the longevity of tool use. Nozzled bottle Lid designed with a snug fit nozzle to push over the Presta valve stem. Presta Thread Lock system, the lid has Presta valve size thread on the inside bottom of the nozzle to secure the bottle to the valve stem when in use. Push the nozzle over the valve stem till it bottoms out then thread it on with a rotation of the bottle. Nozzled Lid compatible with 1refill bottle so making decanting easy and mess-free.

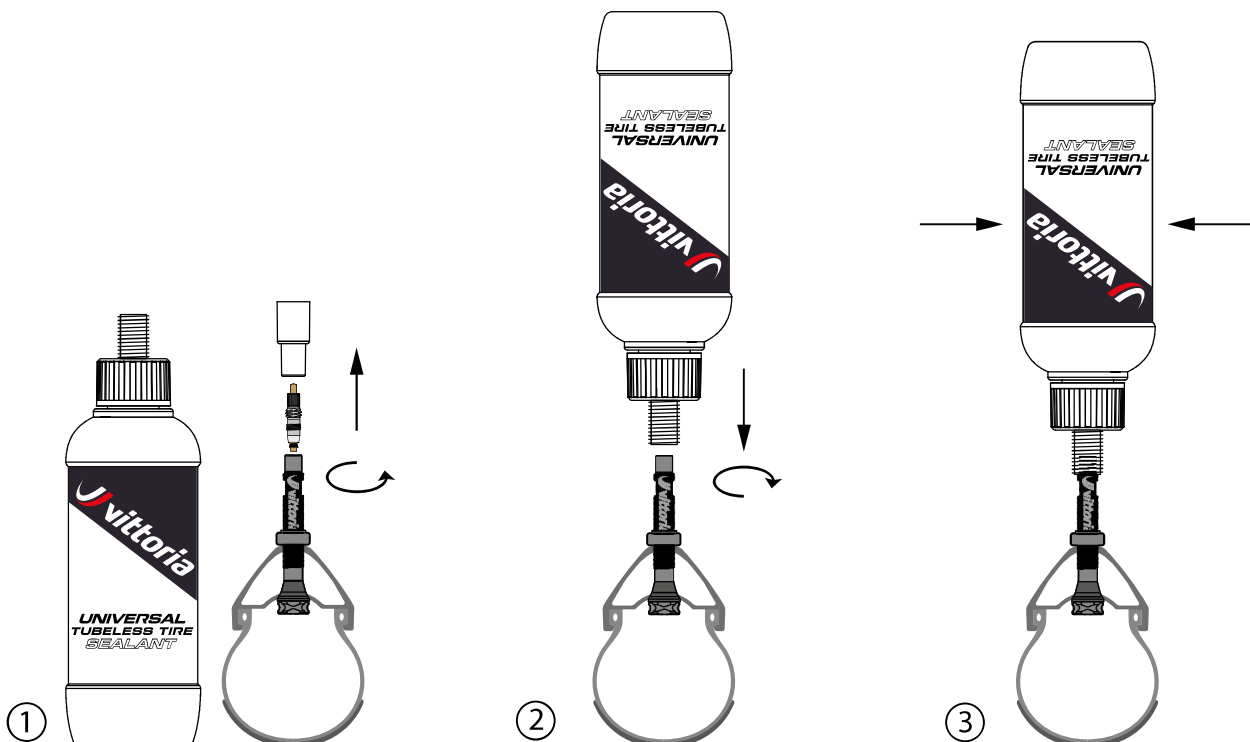

FORMAT AVAILABLE

Vittoria Universal tubeless sealant is available in 5 different formats: 1000ml/500ml/250ml/150ml/80ml. The bottles are made in LDPE for good squeezability. On the side of bottles there are a transparent window for visible volume use. On refill bottles (1000ml/500ml) a graduated numbers show the remaining volume.

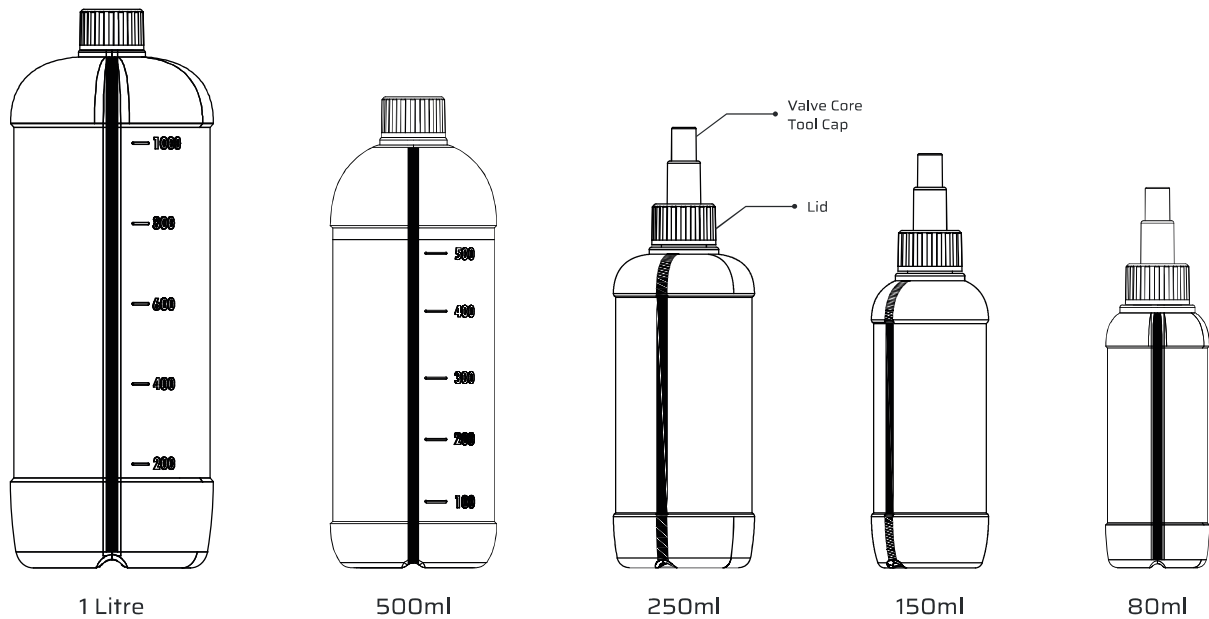

80ml and 150ml available in counter box display.